

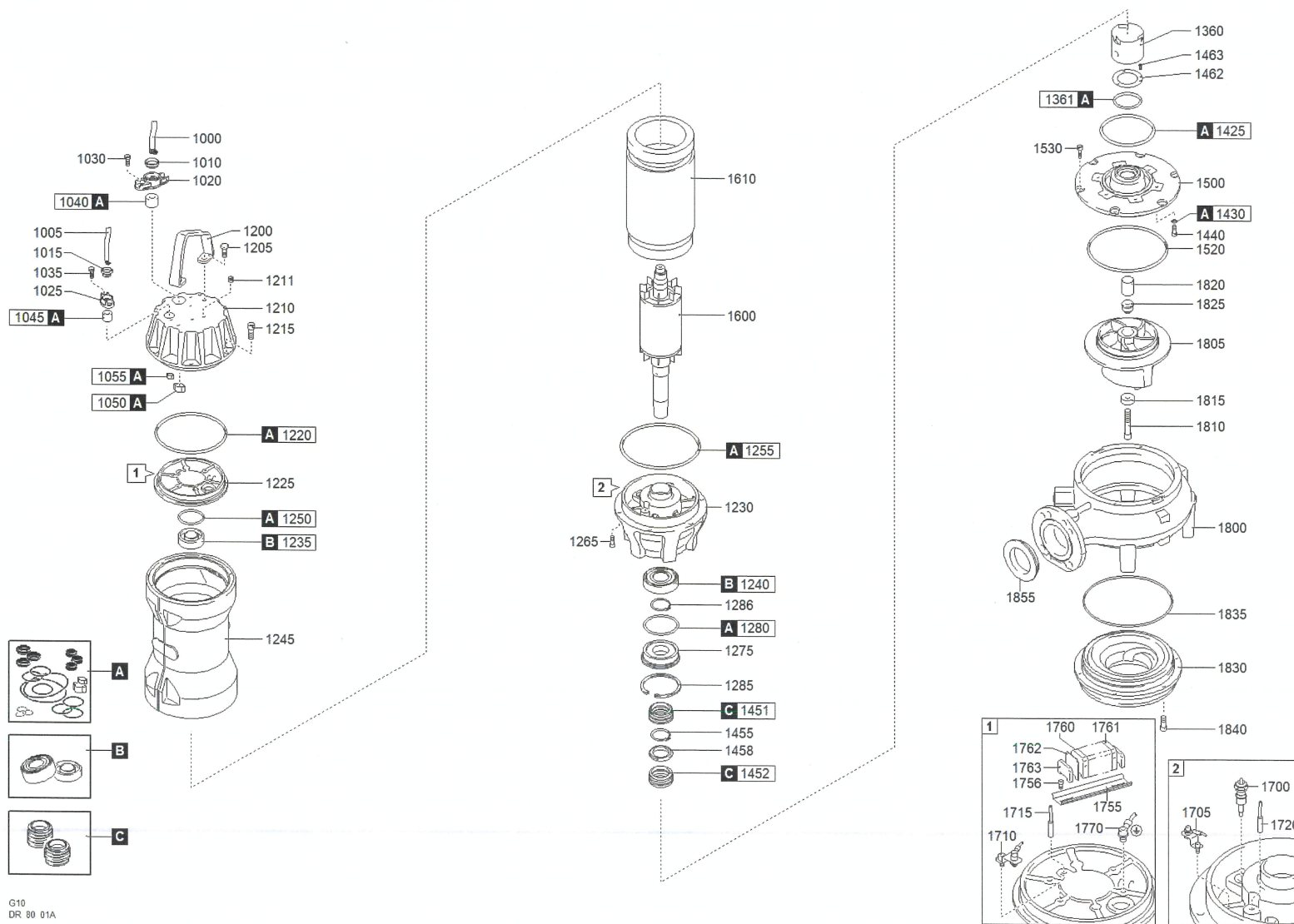

better together

ZENO  
SPARE PARTS

1686.002 - DRG 2500/2/80 W0HT5 NGTSB5104YN00NN





better together



1686.002 - DRG 2500/2/80 W0HT5 NGTSB5104YN00NN

		Code	Description	Q.ty
A		601055001	GASKETS KIT	1
C		602055093	MECHANICAL SEALS KIT	1
B		604055011	BEARINGS KIT	1
1000		25020370251000001	CAVO POTENZA	1
1010		235467216820	RING NUT [POWER CABLE]	1
1010		235467418340	RING NUT [POWER CABLE]	1
1015		235467216820	RING NUT [SIGNAL CABLE]	1
1020		235424018990	CABLE GLAND [POWER CABLE]	1
1020		235424418360	CABLE GLAND [POWER CABLE]	1
1030		270831010203200000	SCREW - CABLE GLAND [POWER CABLE]	2
1040		235673220290	RUBBER GASKET [POWER CABLE]	1
1055		2732001800000	COLLAR CLAMP [SIGNAL CABLE]	1
1200		235233225172	HANDLE	1
1205		270831210251200000	SCREW [HANDLE >> COVER]	2
1210		232117527977	COVER	1
1211		270139510104000000	CAP [TIGHTNESS TEST]	1
1211		270139510104000003	CAP [TIGHTNESS TEST]	1
1215		270831010303200000	SCREW [COVER >> MOTOR CASE]	6
1220		271770209035000000	GASKET [COVER >> UPPER BEARING HOLDER]	1
1225		230657527974	UPPER BEARING HOLDER	1
1230		230517327963	LOWER BEARING HOLDER	1
1235		2729063060200000	UPPER BEARING	1
1240		2729033090200000	LOWER BEARING	1
1245		231017527975	MOTOR CASE	1
1250		271770069035000000	GASKET [UPPER BEARING]	1
1255		271770215035000000	GASKET [MOTOR CASE >> LOWER BEARING HOLDER]	1
1265		270831010303200000	SCREW [LOWER BEARING HOLDER >> MOTOR CASE]	6
1275		23915110056027759	LOWER BEARING FLANGE	1
1280		271770094026000000	GASKET [LOWER BEARING FLANGE]	1
1285		270321100200000	SEEGER [LOWER BEARING FLANGE >> MECHANICAL SEAL]	1
1286		270330450100000	SEEGER [LOWER BEARING >> LOWER BEARING FLANGE]	1
1360		2307303427618	BUSH [OIL CHAMBER]	1
1361		271770082026000000	GASKET - BUSH [OIL CHAMBER]	1
1410		270139530104000000	CAP [OIL CHAMBER]	1
1425		271770145026000000	GASKET [OIL CHAMBER >> PUMP PLATE]	1
1430		271770007017000000	GASKET [PUMP PLATE >> OIL CHAMBER]	6
1430		271770145026000000	GASKET [PUMP PLATE >> OIL CHAMBER]	1
1440		270830810203200000	SCREW [PUMP PLATE >> OIL CHAMBER]	6

1451	230001810450000000	1st MECHANICAL SEAL	1
1452	230002010450000000	2nd MECHANICAL SEAL	1
1455	270330450100000	SEEGER [1st MECHANICAL SEAL >> 2nd MECHANICAL SEAL]	1
1462	270533231159027107	RING [MECHANICAL SEAL]	1
1463	270830610109200000	SCREW - RING [MECHANICAL SEAL]	3
1500	236212684527711	PUMP PLATE	1
1520	271770247026000000	GASKET [PUMP PLATE >> PUMP BODY]	1
1530	270830810203200000	SCREW [PUMP PLATE >> PUMP BODY]	6
1600	2302340138NN27971	SHAFT WITH ROTOR	1
1610	231101383020000000	WOUND STATOR	1
1700	239030807027113	HUMIDITY PROBE [OIL CHAMBER]	1
1755	231320350130000000	BRACKET [TERMINAL BOARD]	1
1756	270530203162000000	SCREW - BRACKET [TERMINAL BOARD]	2
1756	270830510083200000	SCREW - BRACKET [TERMINAL BOARD]	2
1760	2553021000000000	POWER CABLE TERMINAL [TERMINAL BOARD]	6
1760	2553021000000000	POWER CABLE TERMINAL [TERMINAL BOARD]	6
1761	2553020600000000	SIGNAL CABLE TERMINAL [TERMINAL BOARD]	3
1762	2553040600000000	TERMINAL CAP [TERMINAL BOARD]	1
1763	2553064000000000	TERMINAL LOCKING [TERMINAL BOARD]	2
1770	2500024080000000	GROUND CABLE CONNECTOR	1
1770	270530604204000000	GROUND CABLE CONNECTOR	1
1770	270830810123200000	GROUND CABLE CONNECTOR	1
1800	21251026835526880	PUMP BODY	1
1805	21411OC195NN28316	IMPELLER	1
1810	270831210903200000	LOCKING IMPELLER	1
1815	270531021959028089	LOCKING WASHER [IMPELLER]	1
1820	2307403425542	BUSH [IMPELLER]	1
1825	2307303425877	RING NUT [IMPELLER]	1
1830	2162126828323	SUCTION FLANGE	1
1835	271770247026000000	GASKET [PUMP BODY >> SUCTION FLANGE]	1
1840	270830810203200000	SCREW [SUCTION FLANGE >> PUMP BODY]	6